

ATLANTA

STRETCH

HMI PANEL USER MANUAL WEINTEK MT8071iP/ECO BETA VERSION

Lingua	Revisione	Data	Autore	Pag. Mod	Descrizione
IT	Rev_00	27/12/2022	G.Pazzaglini		Description of functions and navigation on Weintek MT8071iP/ECO HMI panel Beta version
				1	

HOMEPAGE

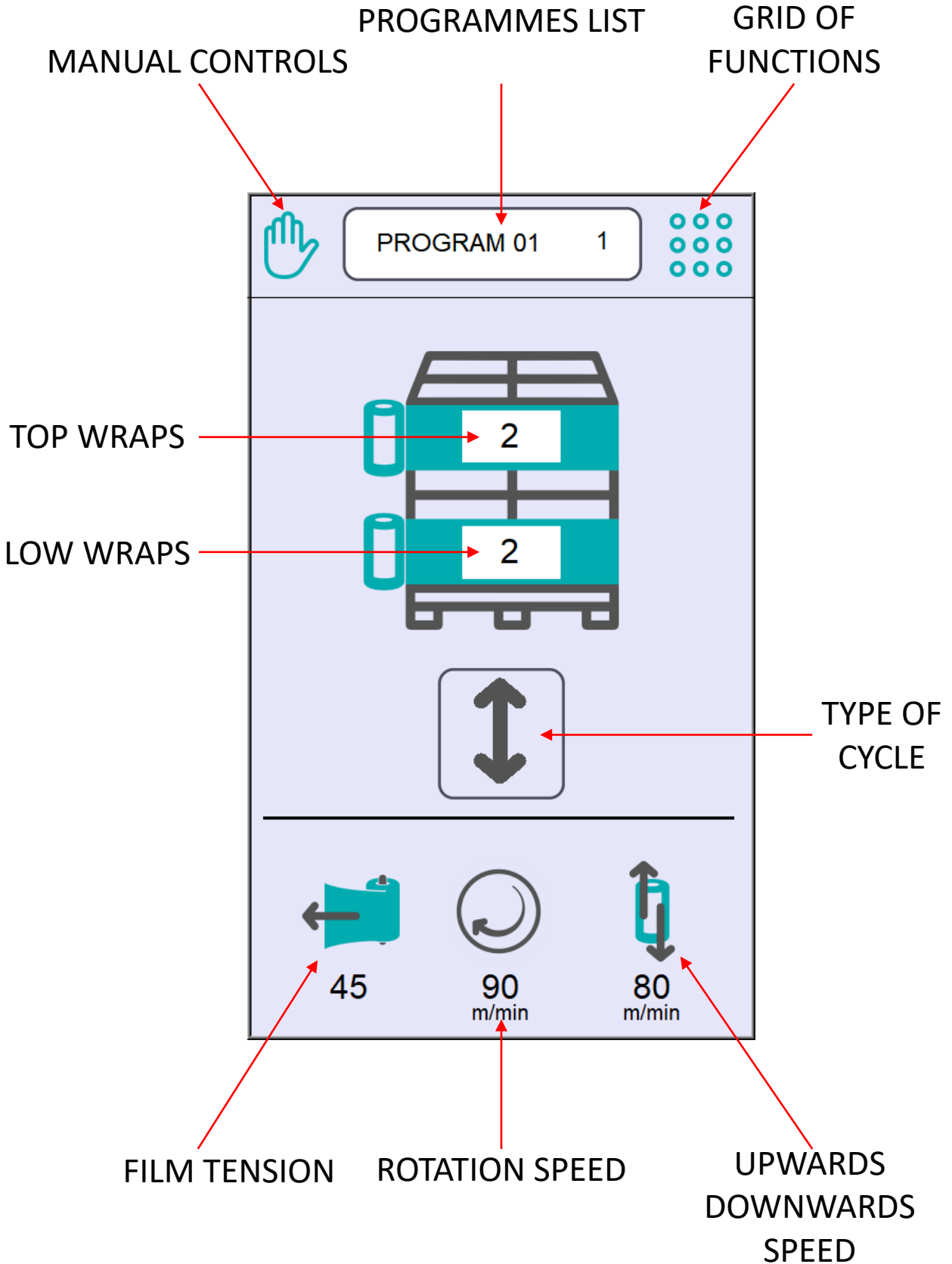

MANUAL CONTROLS



PRESSURE UNIT (Only for rotary tables) SPOOL CARRIAGE ROTATION (Only for rotary tables)

These controls allow the top press (if fitted), carriage and table to be moved manually. The movement action remains as long as the buttons are pressed.

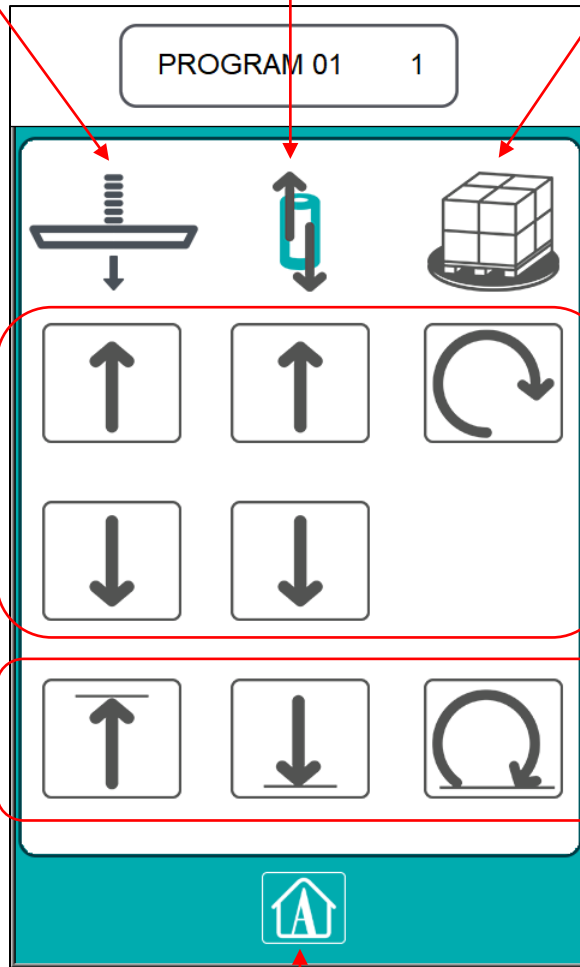

These commands enable automatic home position search.

- Top press : high end stop
 - Carriage: low end-stop
 - Turntable : home position
- Press once without holding down the command.

HOME ICON

This is the 'SAVE+Back' button and combines the functions of saving and returning to the previous window.

In this screen, it allows you to return to the Homepage

PROGRAMMES LIST

The programme names are listed in the programme list. By default, each programme is called 'PROGRAM XX' where XX is the programme number in succession.

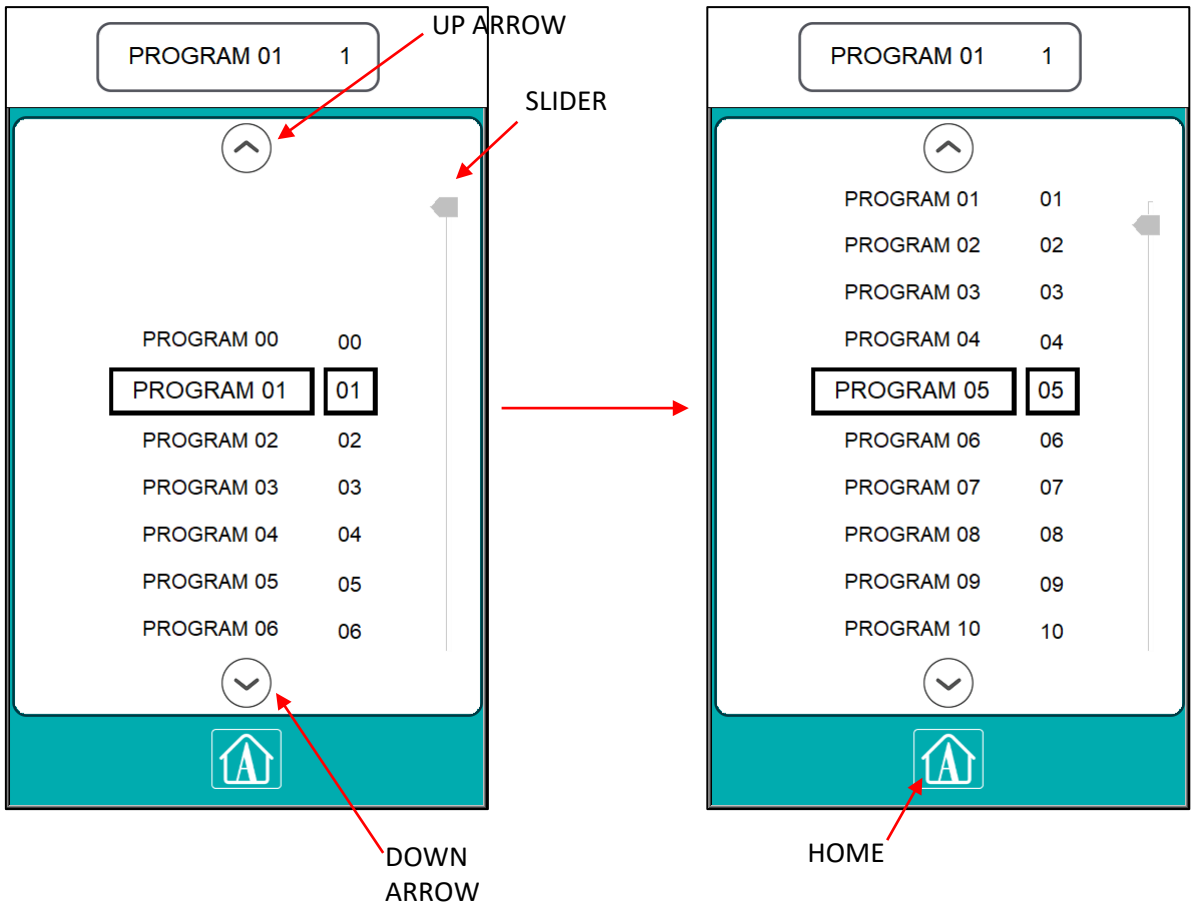

With the UP ARROW and DOWN ARROW buttons you can scroll through the programme list. Pressing once on either arrow scrolls by 1 programme, holding down an arrow has no effect. To scroll faster you can use the VERTICAL SLIDER on the right, by holding it down and scrolling up/down in the list.

Clicking on the Home button will change the current programme to the one selected in the black rectangle, and all function values of that programme will be loaded.

PROGRAMMES LIST

By selecting the desired programme and pressing for at least 3s on the programme name, it is possible to rename the selected programme

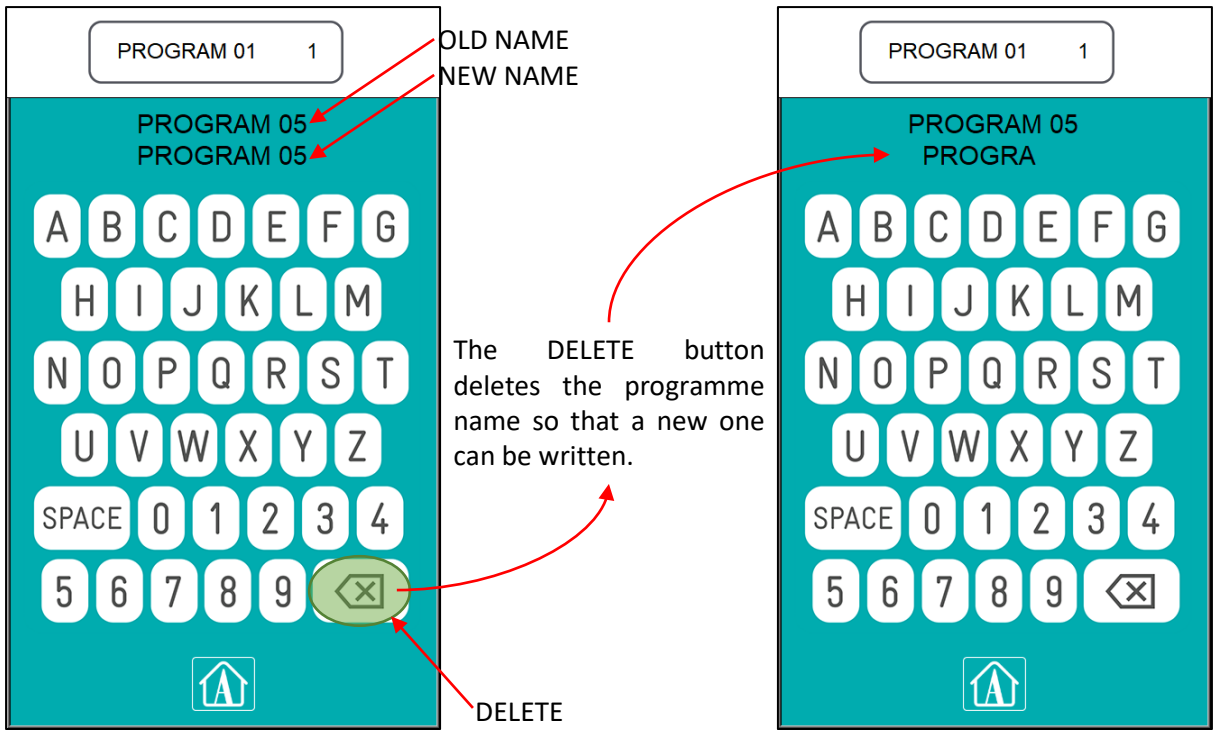

You have 10 characters including spaces. When the new name is complete, save it by pressing the HOME button, so that you also return to the programme list. The new programme has now been renamed and saved. As you can see from the pictures below, this only renames. You can see the active programme on the machine in the white rectangle above. To change the programme, therefore, carry out the procedure shown on the previous slide.

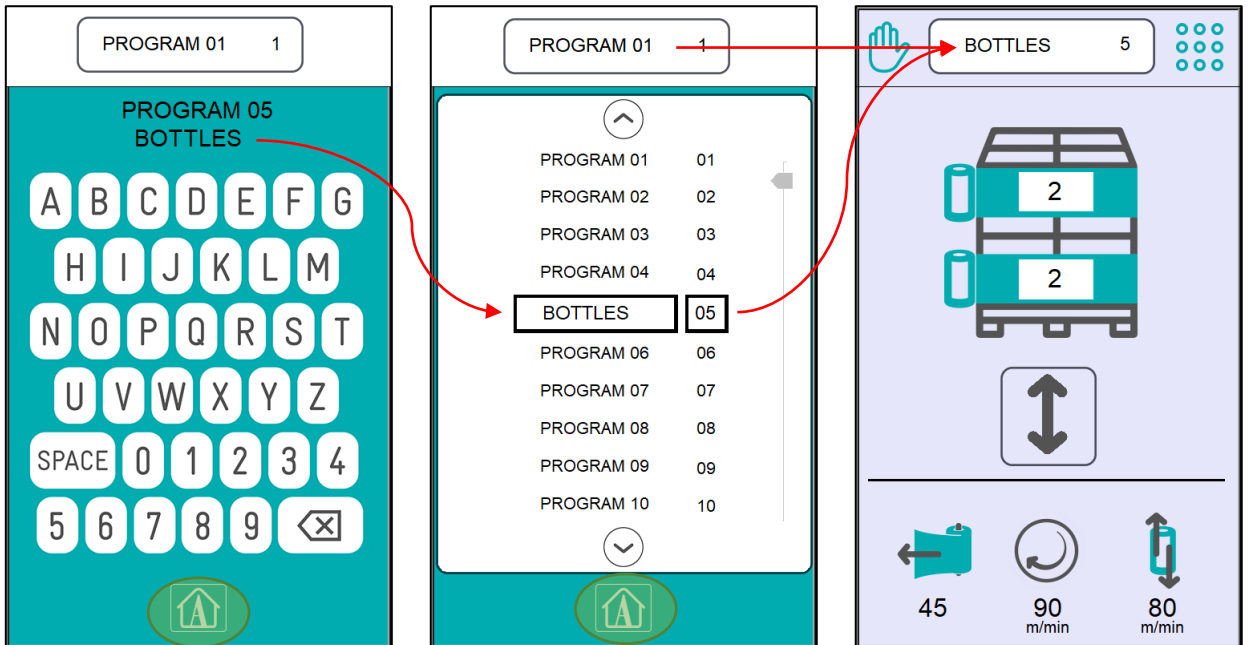

TIPE OF CYCLE

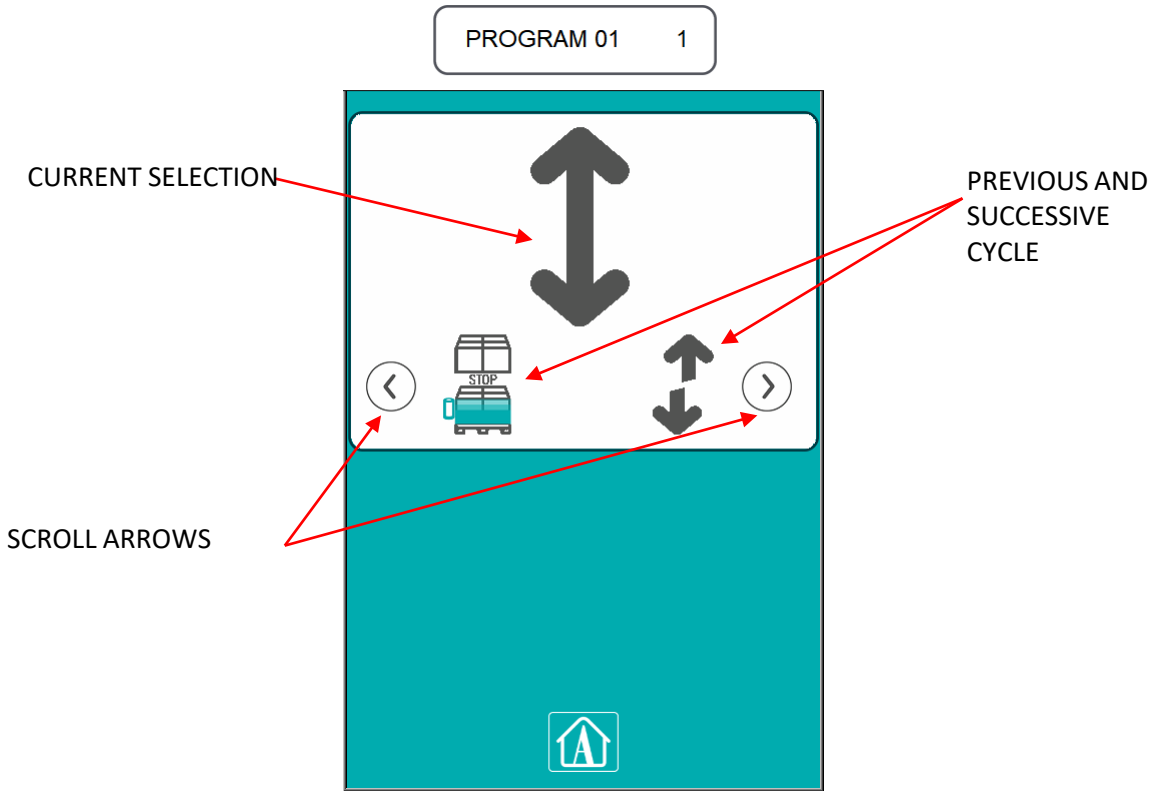

The cycle type is selected here. If this has been activated, it will be selectable. Use the ARROWS to scroll left and right in the menu and the selected cycle type will be displayed large in the centre. To confirm the selected cycle press the HOME button in the centre and you will return to the previous screen. Please refer to the machine's "Operating Panel Instruction Manual" for details of cycle operation. The cycles are as follows:

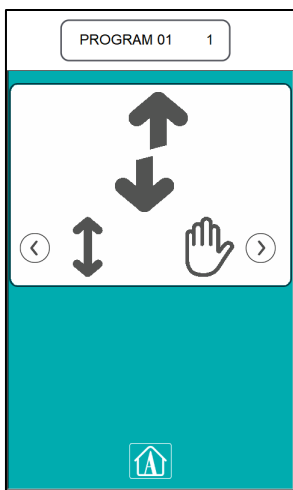

ONLY UP / ONLY DOWN CYCLE

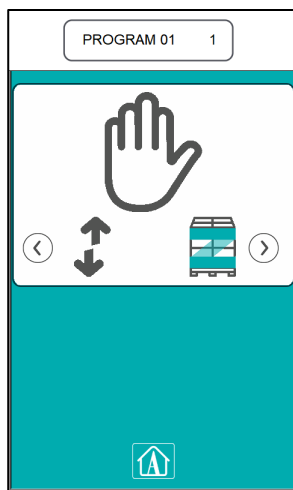

MANUAL CYCLE

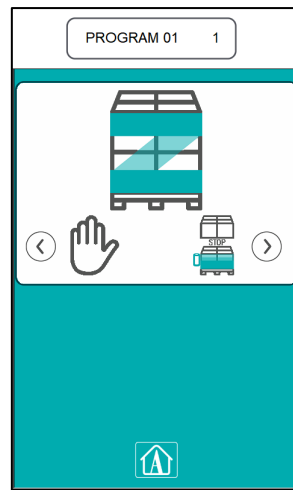

FAST CYCLE

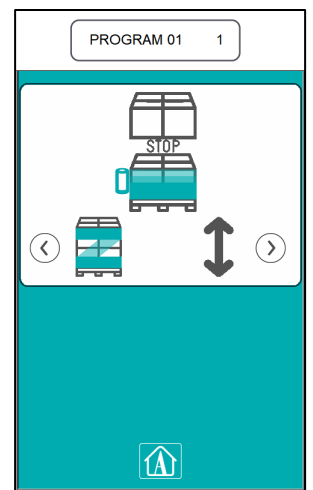

LAYER CYCLE

TOP WRAPS / LOW WRAPS

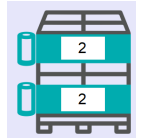

Here you can set the number of TOP and LOW WRAPS using the '+' and '-' buttons.

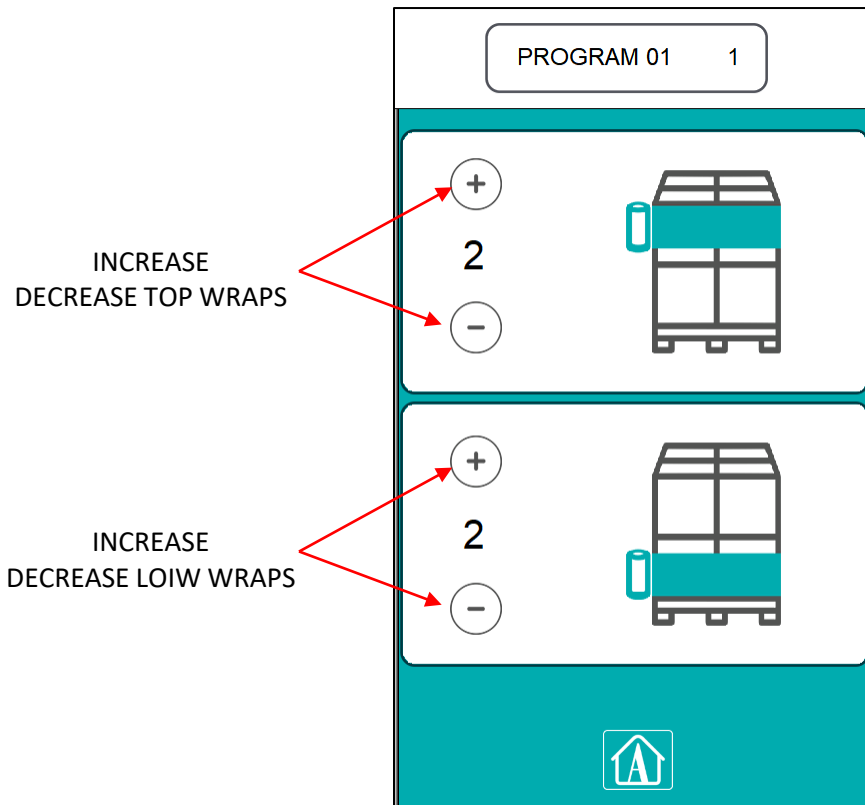

IMPORTANT: The change to the Number of wraps does not take effect until the HOME button at the bottom centre is pressed, since home button has a save function. So the change of values within the screen remains not confirmed (not executed by the programme) until the HOME button is pressed and then until saved.

The procedure for changing a value is:

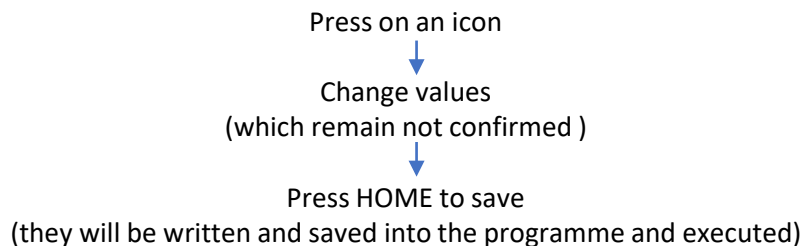

Example. You enter this screen to change the low wraps to 5. It is initially set to 2 and is changed to 5 BUT the HOME button is not pressed yet. The programme therefore still has the value 2 in memory. When the cycle starts the programme will execute 2 low wraps. **To confirm the change the operator should have pressed the HOME button.** Thus the programme would have executed 5 low revolutions.

This is valid for all functions: when they are changed, this change will only take effect when the HOME button is pressed.

FILM TENSION

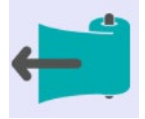

Here you can set the FILM TENSION

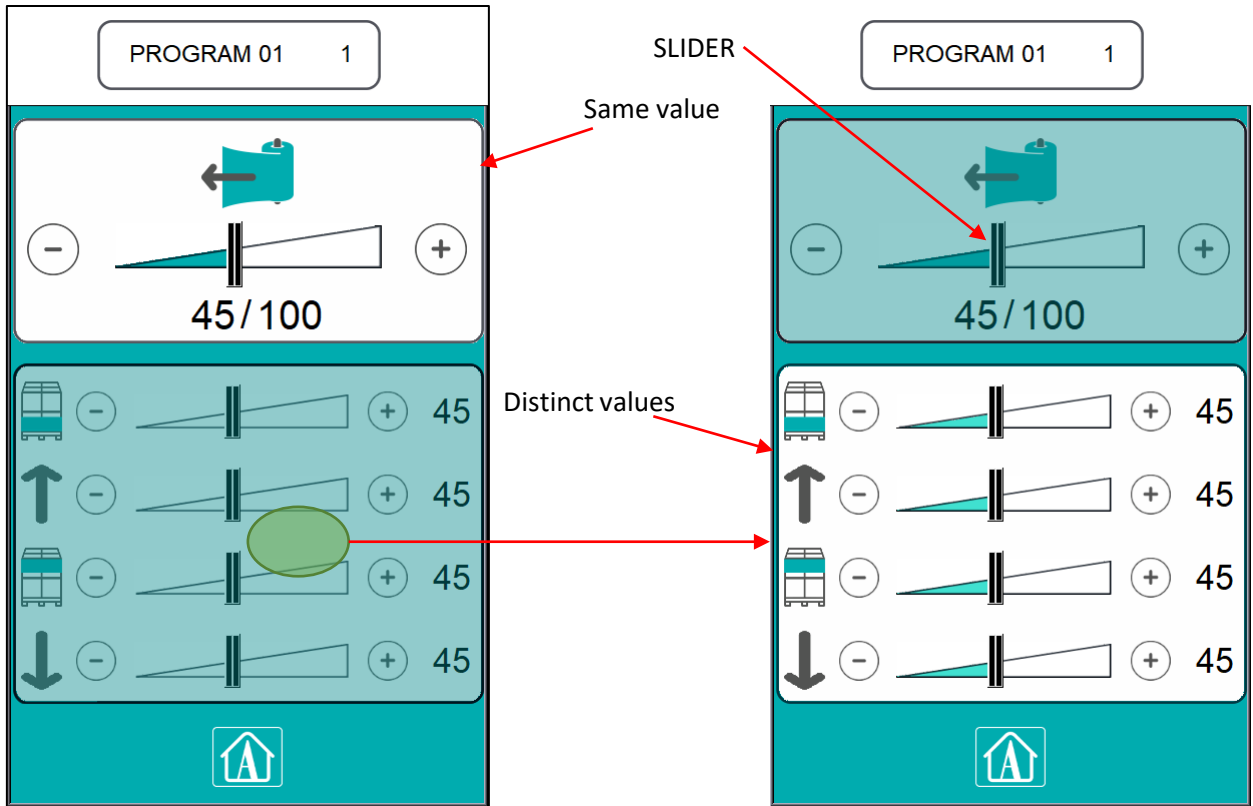

In this screen you can adjust the film tension in 2 ways:

- Setting a single value, the same for all phases of the cycle
- Setting 4 separate values

To switch between the two modalities, simply press on the dark area.

To change values by 1 unit use the '+' and '-' buttons. For faster changing you can drag the slider to the left and right. To save, press the HOME button.

The currently active shooting values will also be displayed in the HOMEPAGE

ROTATION SPEED



Here, the turntable's ROTATION SPEED can be adjusted using the '+' and '-' buttons. For faster editing, the SLIDER can be dragged left and right. To save, press the HOME button.

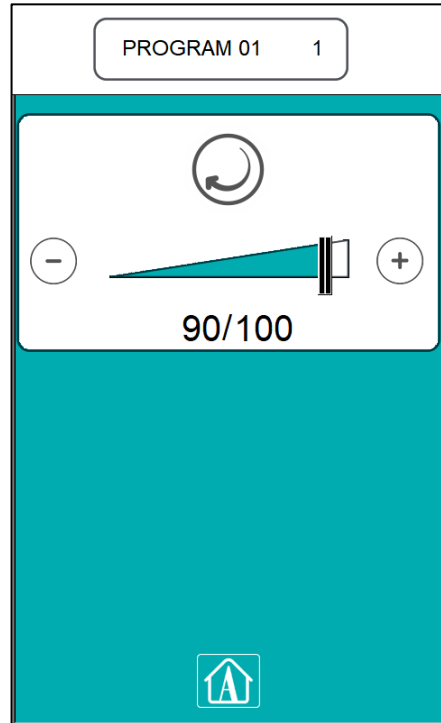

UP / DOWN SPEED OF THE SPOOL CARRIAGE



Here you can adjust the up and down speed of the SLIDER using the '+' and '-' buttons. For faster editing, the SLIDER can be dragged left and right. To save, press the HOME button. As in the previous slide, you can choose between selecting a single speed for ascent and descent, or set them separately.

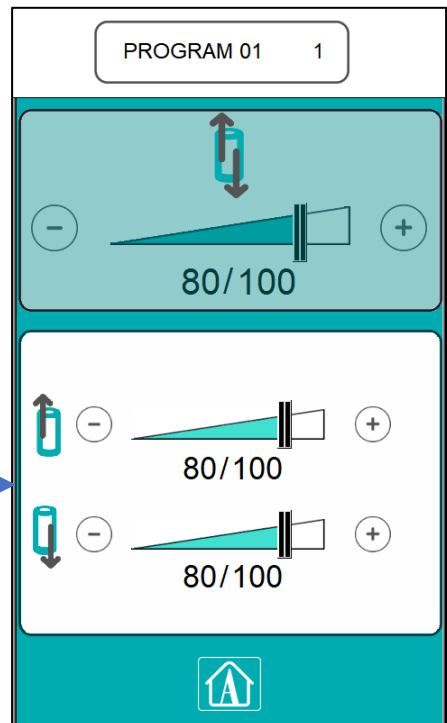
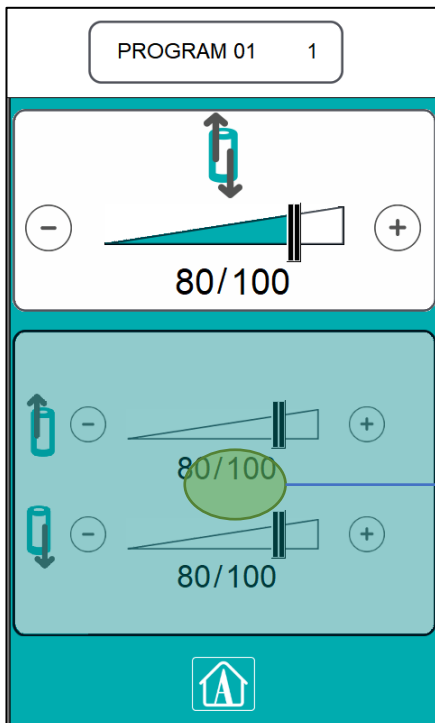



FUNCTIONS GRID

The icons of the various functions present and active on the machine are shown here. Use the arrows at the top right/left to scroll through the functions. Functions have a representation of their status (ON/OFF) or set value on the outside. Press the HOME button to return to the HOMEPAGE.

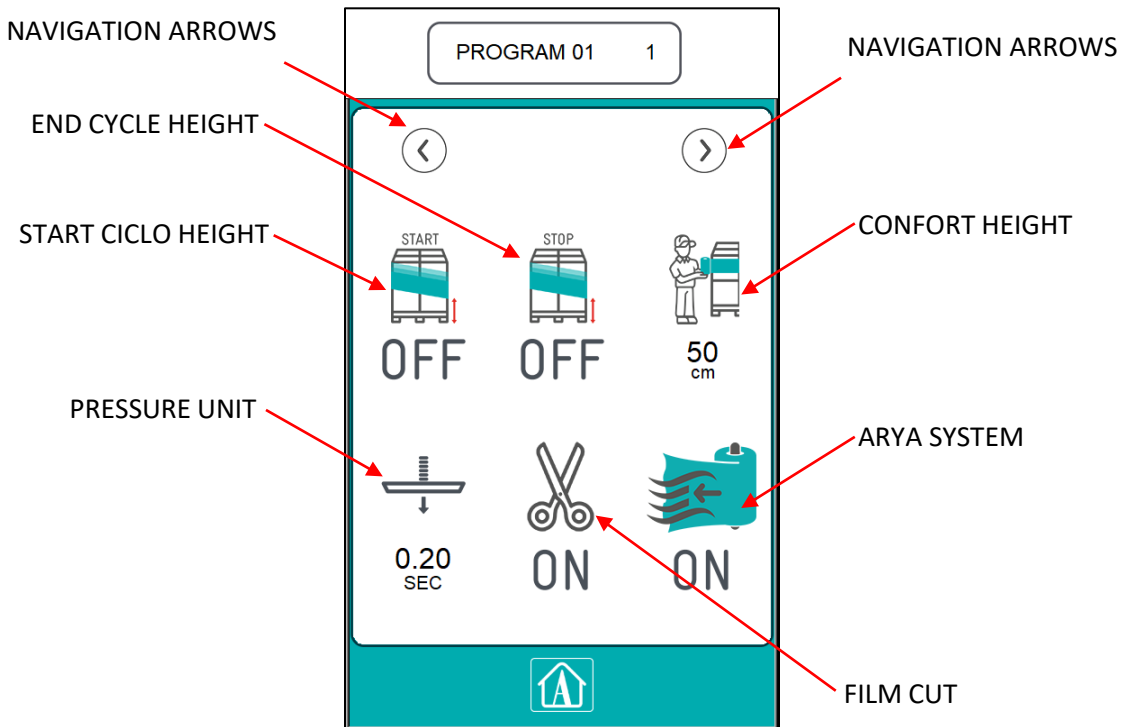
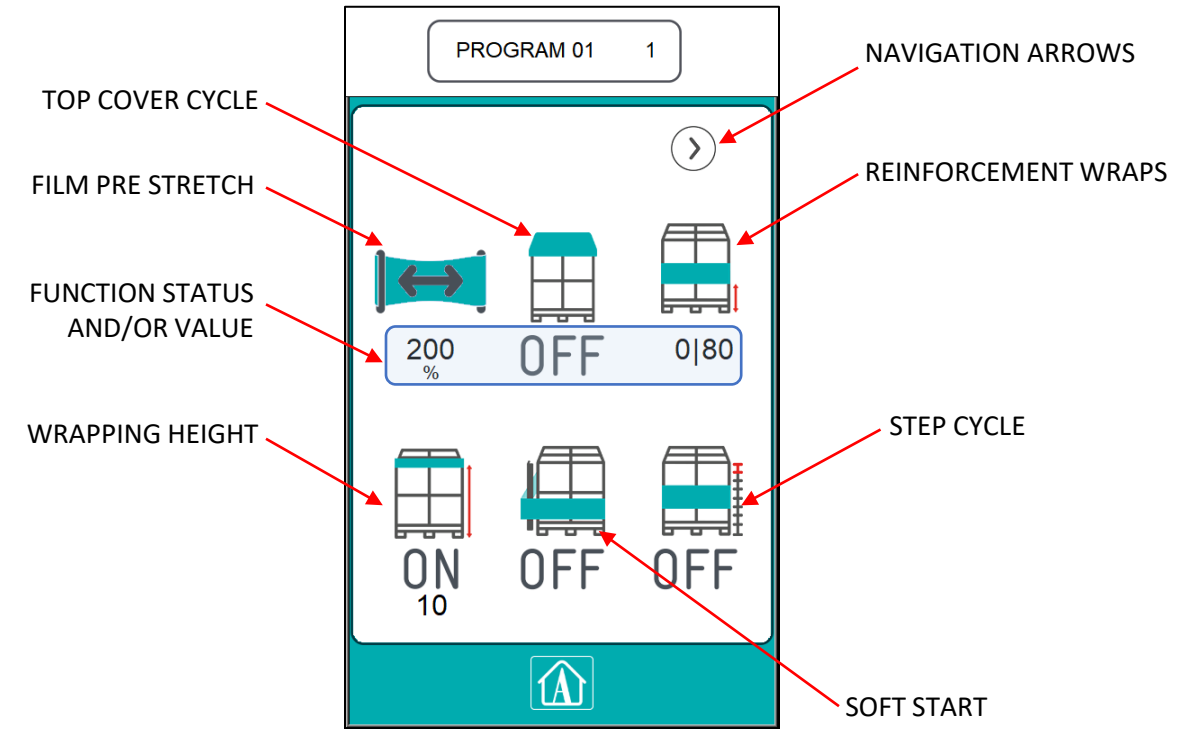



FUNCTIONS GRID

This is the restricted area for technicians, not accessible by the user



FILM PRE STRETCH



Here you can adjust the FILM PRE STRETCH using the '+' and '-' buttons. For faster setting, the SLIDER can be dragged left and right. To save, press the HOME button. You can choose between selecting a single speed for upwards / downwards, or set them separately.

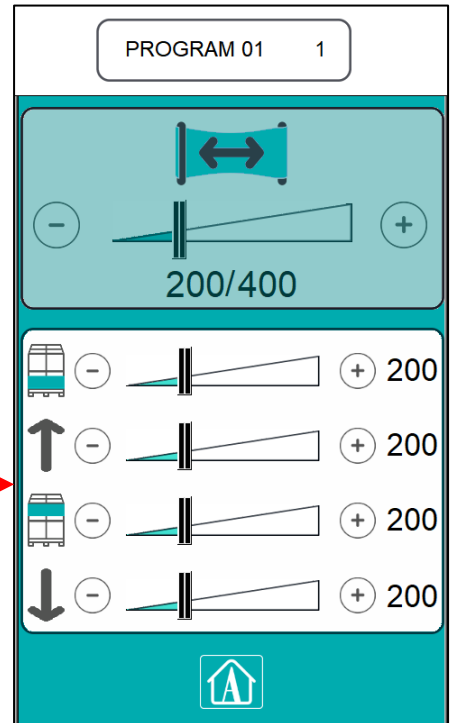
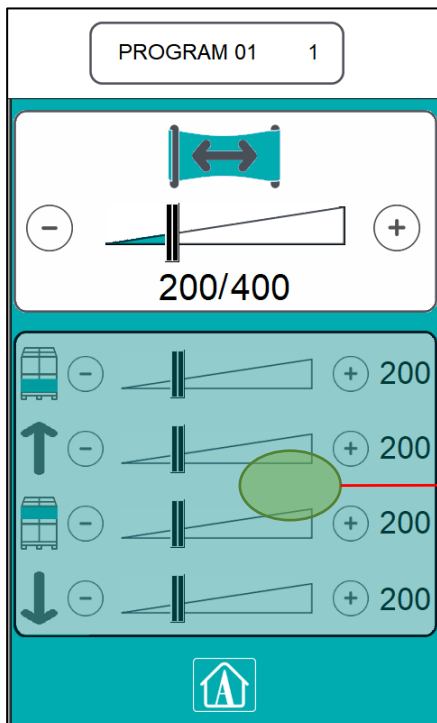



TOP COVER CYCLE

Here you can activate/deactivate the TOP COVER CYCLE by pressing the ON/OFF switch. In the screen below, the downward height of the carriage during the cover-laying phase is indicated. This measure can be changed using the '+' and '-' buttons. For a faster change you can drag the SLIDER up and down. To save, press the HOME button, returning to the functions grid.

PROGRAM 01 1

ENABLING
DISABLING TOP
COVER CYCLE

DOWNWARD
HEIGHT OF THE
CARRIAGE

OFF ON

25 cm

HOME

REINFORCEMENT WRAPS

Here, the REINFORCEMENT WRAPS and the REINFORCEMENT QUOTE at which they are to be performed can be set. The value is changed using the '+' and '-' buttons. For faster editing, the SLIDER can be dragged left and right. To save, press the HOME button, returning to the function grid.

PROGRAM 01 1

REINFORCEMENT
WRAPS

REINFORCEMENT
QUOTE

0

80 cm

HOME

WRAPPING HEIGHT



Here, you can set HOW the WRAPPING HEIGHT is detected.

The green/red switch below the photocell symbol allows you to switch between the two HEIGHT DETECTION modes:

-Using the photocell, automatic height **green selector switch, ftc activated**

-By setting a height in cm, manual height **red selector, ftc deactivated**

When the photocell is activated, an additional wrapping quote can be added using the '+' and '-' buttons. When the photocell is deactivated the wrapping height has to be set manually by means of the "+" and "-" buttons at the bottom of the screen, or for a faster change you can drag the SLIDER up and down. To save, press the HOME button, returning to the function grid.

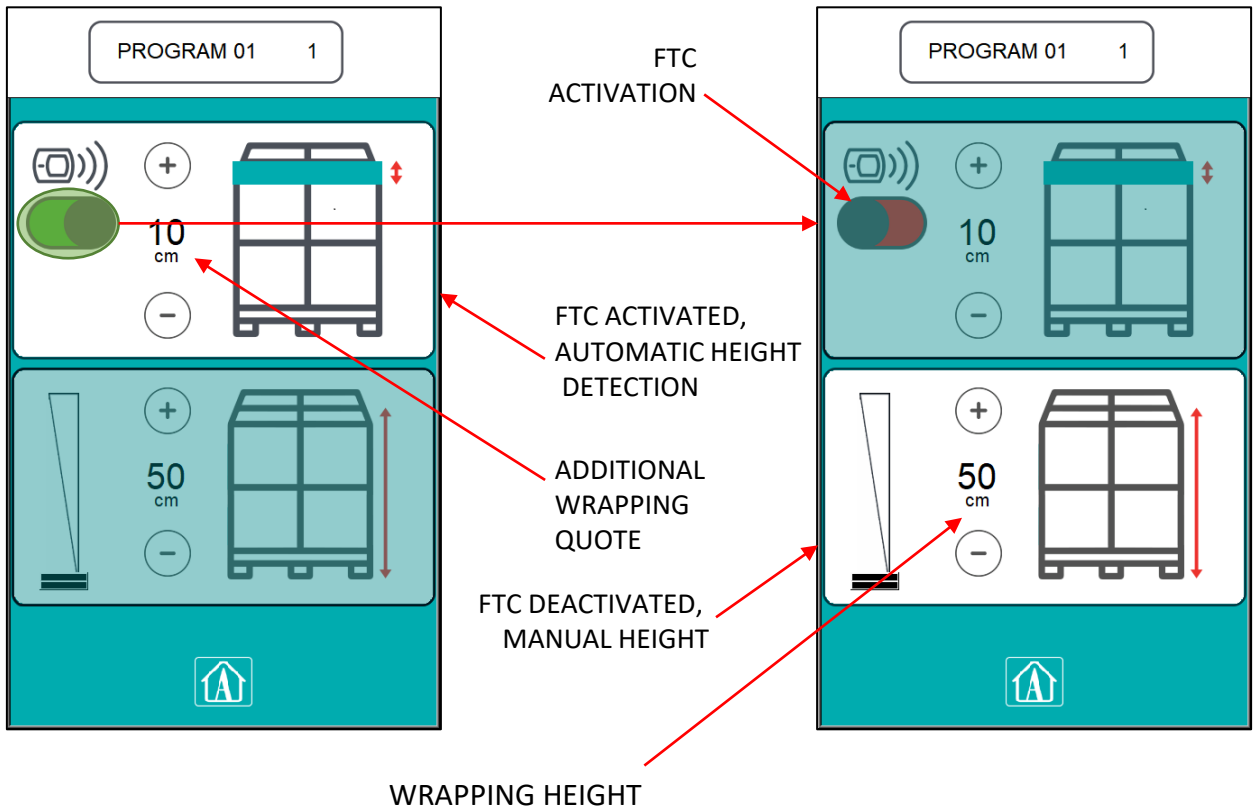



SOFT START

Here you can activate/deactivate the SLOW START by pressing the ON/OFF switch. In the screen below, the seconds of slow rotation of the turntable at the beginning of the cycle are indicated. This time can be changed using the '+' and '-' buttons. For faster editing, you can drag the SLIDER up and down. To save, press the HOME button, returning to the function grid.

PROGRAM 01 1

ACTIVATION DEACTIVATING SOFT START

OFF ON

1 SEC

SLOW ROTATION DURATION

HOME

STEP CYCLE

Here you can activate/deactivate the STEP CYCLE by pressing the ON/OFF switch. In the top box, the number of wraps to be performed at each step and the step height are indicated. In the box below, it is possible to choose the tension and the prestretch to be applied during the step cycle.

All values can be changed using the '+' and '-' buttons. For faster editing, you can drag the SLIDER to the right and left. To save, press the HOME button, returning to the functions grid.

PROGRAM 01 1

ACTIVATION DEACTIVATING SOFT START

NUMBER OF WRAPS 0 40 cm

HEIGHT OF THE STEP

TENSION DURING STEP CYCLE 40

PRE STRETCH DURING STEP CYCLE 200

HOME

START CYCLE HEIGHT

Here you can activate/deactivate the CYCLE START HEIGHT by pressing the ON/OFF selector. In the screen below, the height (in centimetres) of the carriage during the initial phase of the cycle indicates the wrapping start height. This height can be changed using the '+' and '-' buttons. For faster editing, you can drag the SLIDER up and down. To save, press the HOME button, returning to the functions grid.

ACTIVATION
DEACTIVATING
START CYCLE
HEGHT

START CYCLE
HEGHT

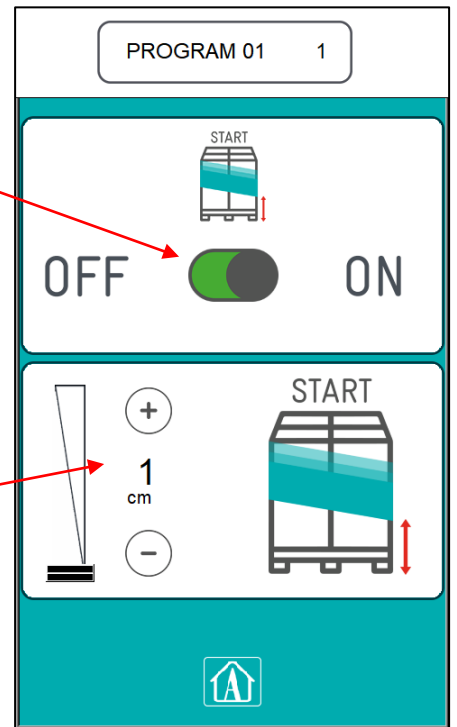

STOP CYCLE HEIGHT

Here the CYCLE STOP HEIGHT can be activated/deactivated by pressing the ON/OFF switch. In the screen below, the height (in centimetres) of the carriage during the final phase of the cycle indicates the wrapping stop height. This height can be changed using the '+' and '-' buttons. For a faster change you can drag the SLIDER up and down. To save, press the HOME button, returning to the function grid.

ACTIVATION
DEACTIVATING
STOP CYCLE
HEGHT

STOP CYCLE
HEGHT

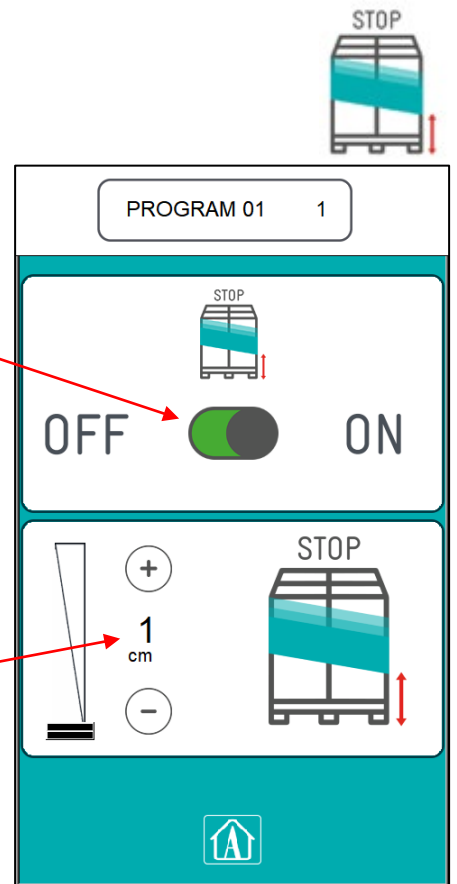



CONFORT HEIGHT

Here you can activate/deactivate the CONFORT QUOTA at the end of the cycle by pressing the ON/OFF switch. As shown in the box below, if the comfort quota is activated at the end of the cycle, the carriage will rise to the indicated quota (in centimetres). This height can be changed using the '+' and '-' buttons. For faster editing you can drag the SLIDER up and down. To save, press the HOME button, returning to the function grid.

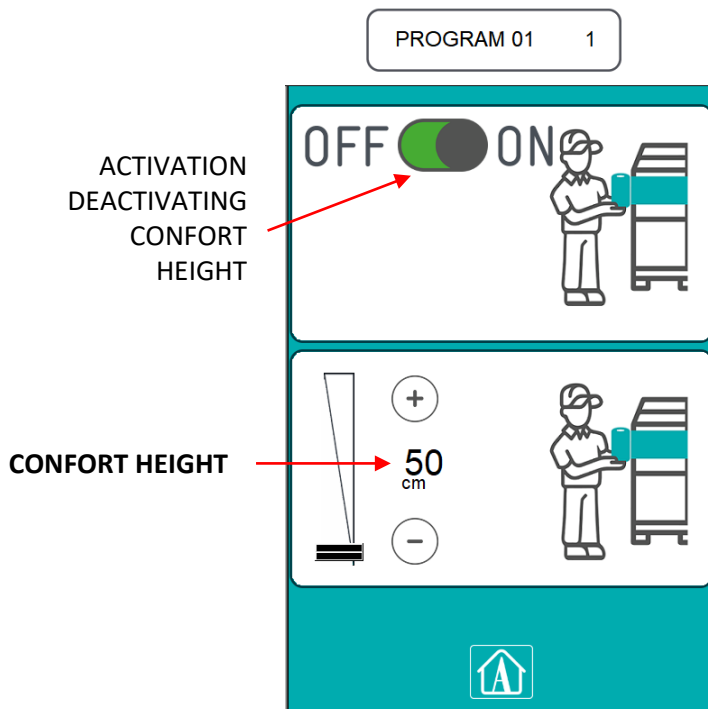

PRESSURE UNIT

Here you can activate/deactivate the pressure unit. The display below shows the stop delay of the pressure plate during descent (increasing this value makes the pressure of the plate on the product increase). The value is changed using the '+' and '-' buttons. For faster editing you can drag the SLIDER up and down. To save, press the HOME button, returning to the function grid.

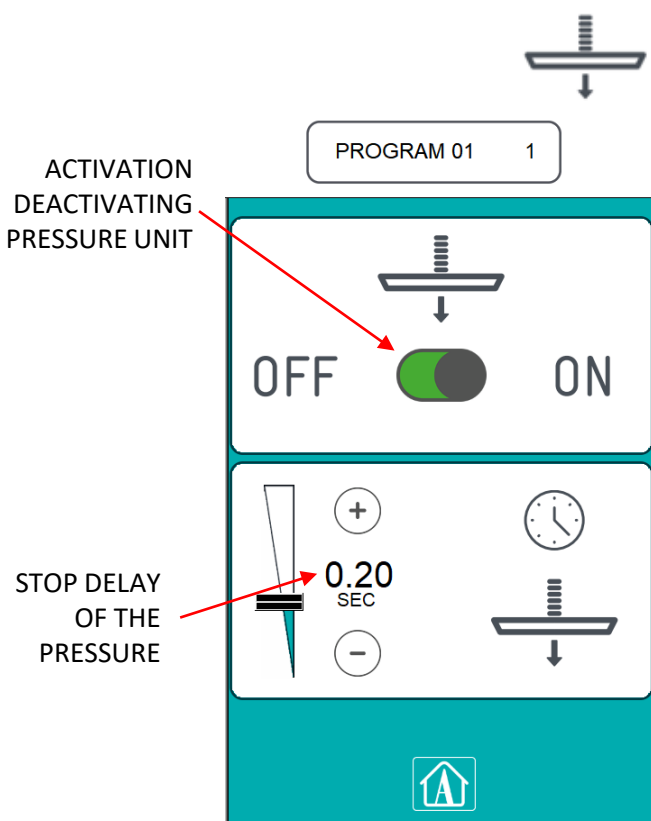



AUTOMATIC FILM CUT

Here you can activate/deactivate AUTOMATIC FILM CUT at cycle end by pressing the ON/OFF switch. To save, press the HOME button, returning to the function grid.

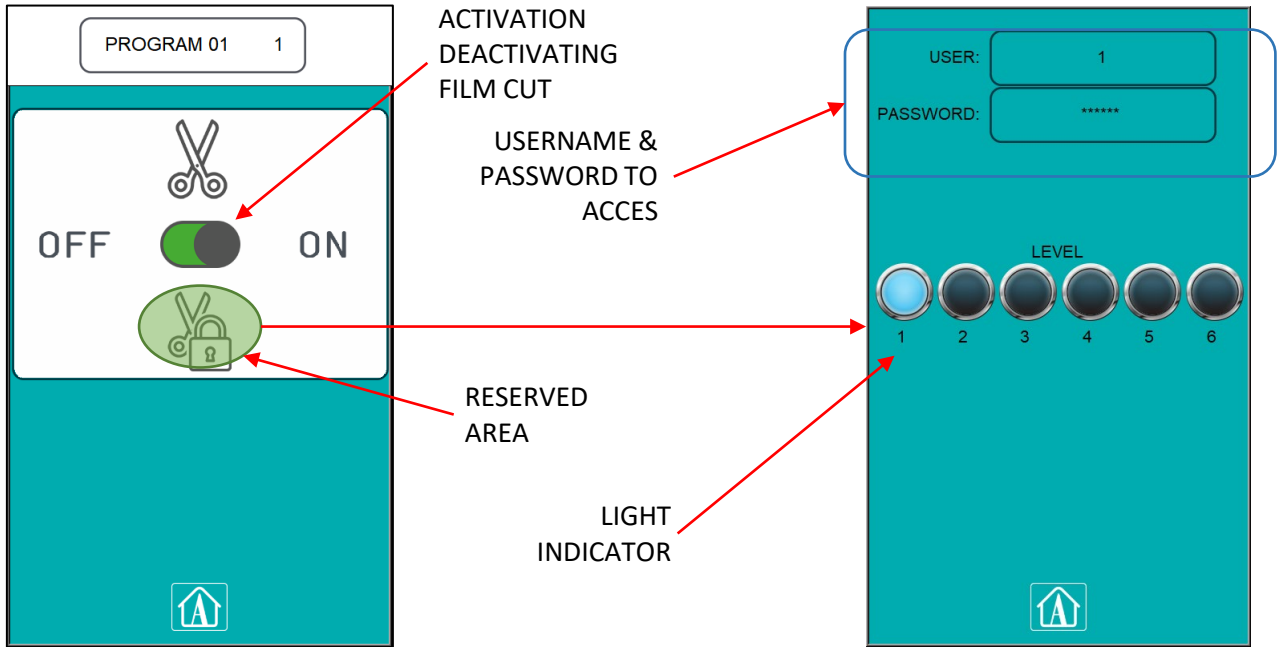

By pressing on the padlock icon, you will access a reserved area where you can change the 2 parameters related to film cutting. A new window will invite you to enter USER= [1] and PASSWORD=[111111] (enter the number 1 six times). Then 6 indicator lights will appear: if the operation was successful, indicator 1 will be on, otherwise an error occurred and you will have to repeat the procedure to access again. Then press the HOME key to access the parameter editing. In the screen below you can activate the double cutter stroke, modify the film tension time before cutting and the film tension time after cutting (before tearing). These two values are usually set during the test phase and do not need to be changed routinely. When you have finished editing, press the HOME button to save and return to the previous screen.

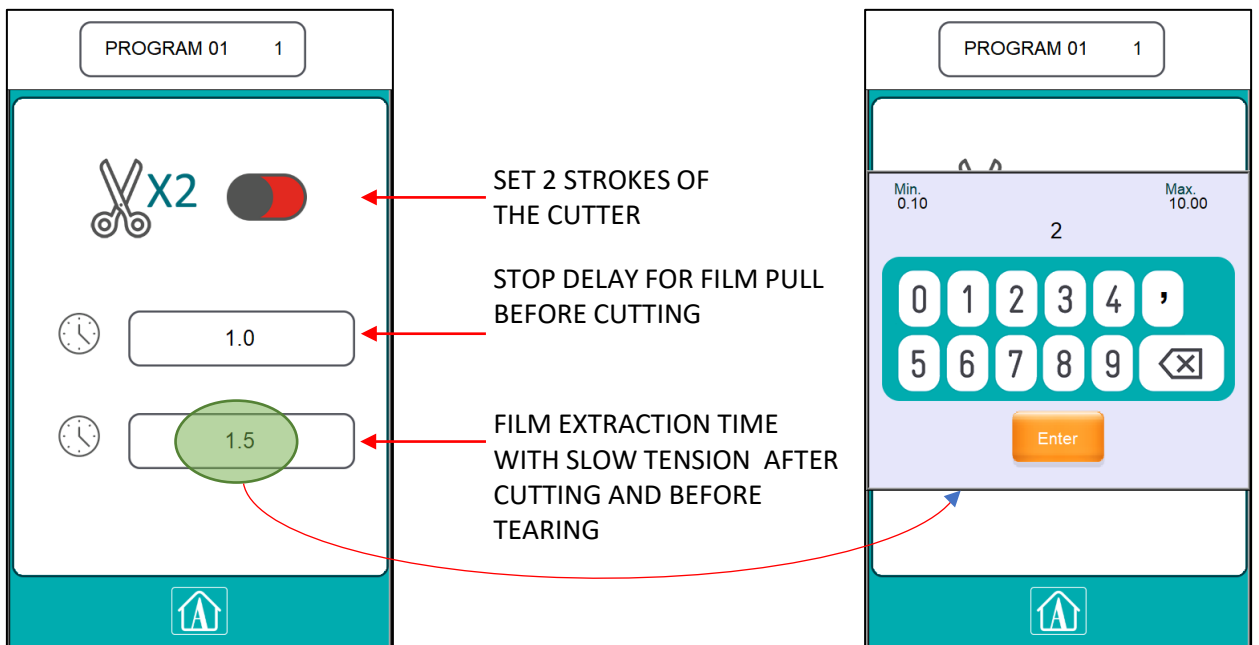

ARYA SYSTEM



Here you can activate/deactivate the ARYA System at the beginning of the cycle by pressing the ON/OFF switch. Access to the reserved area for editing Arya System parameters is not available in the beta version of the panel, it will be available in future releases. To save, press the HOME button, returning to the function grid.

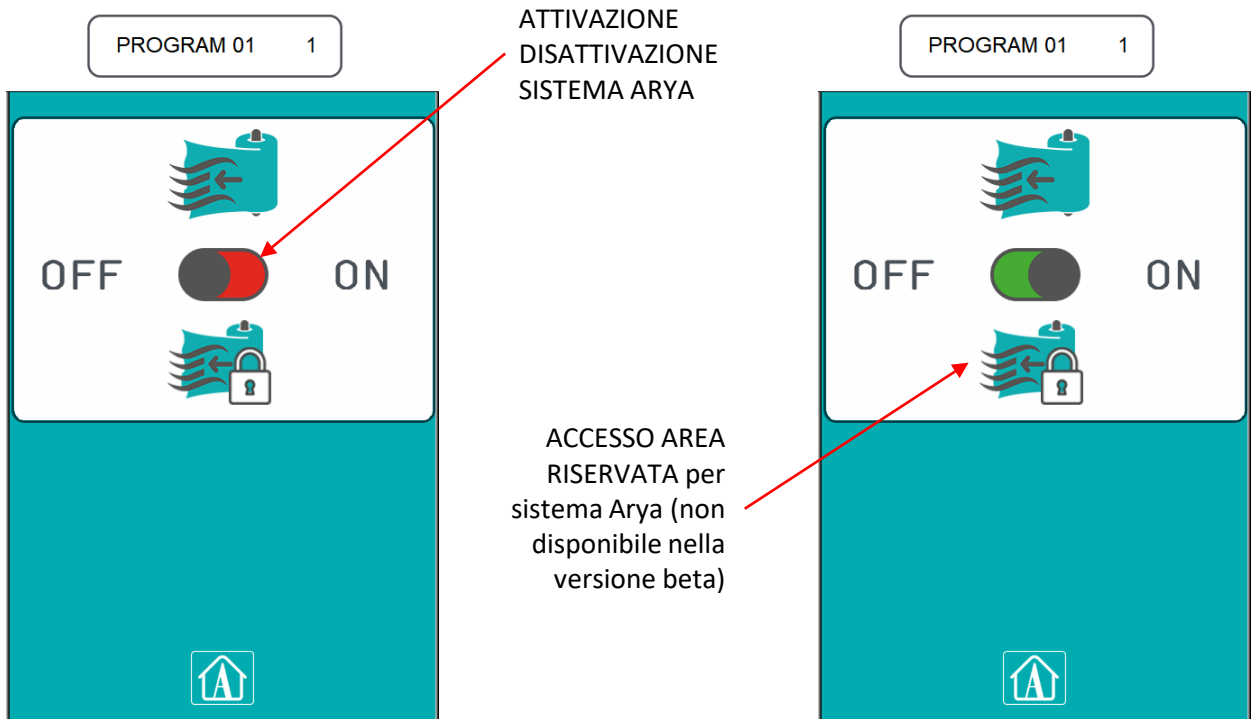

Access to the restricted area for editing Arya System parameters is not available in the beta version of the panel, it will be available in future releases

MACHINE ALARM

When the machine is in alarm mode, this red screen is displayed. It shows:

- The code of the alarm on the machine
- The QR code with a link to the machine's panel manual, with the list of alarms and how to solve them
- The panel RESET button

When the problem is resolved, the RESET button on the display can be pressed to resolve the alarm. If the alarm concerns the machine's emergency circuit, it may be necessary first to press the BLUE RESET button below the display. If several different alarms occur at the same time, when the RESET button on the display is pressed, the alarm code at the top may change, thus indicating that there is another error in addition to those already resolved.

When the alarms are resolved, the screen will turn green when the reset button is pressed. Then press the HOME button to return to the previous screen.

